

MODULAR STEEL BRIDGE

BAILEY BRIDGE SYSTEM



PRODUCT BROCHURE

OVERVIEW

ZhengJiang Great Wall Heavy Industry Technology Co. Ltd. (Great Wall) is located at Zhengjiang city in Jiangsu Province, China.

The Great Wall Modular Steel Bridge system adopts the world most popular Bailey Bridge, which uses standardized components to create a versatile heavy duty modular steel bridge system that combines strong and durable structure with fast construction speed.

The Great Wall Modular Steel Bridge system is the ideal solution for rapid, durable and worthy for permanent or temporary bridging, military bridging, disaster relief operation as well as replacement of damaged bridge.

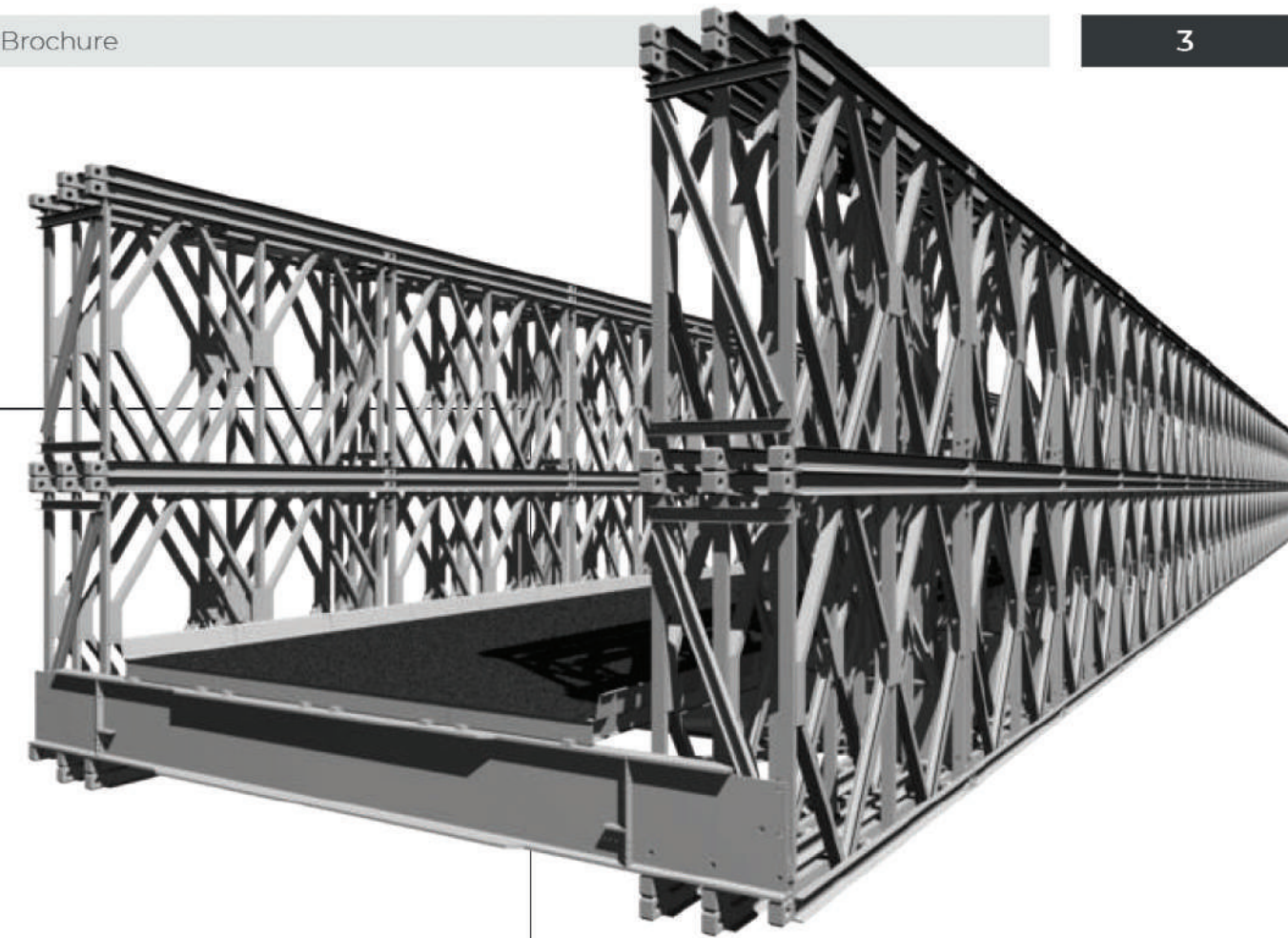

Great Wall bridge is not only well-known in China, but also won good reputation overseas; the bridges made by Great Wall have been used all over the world exported to Indonesia, Nepal, Mozambique, Kenya, Republic of the Congo, Myanmar, Mongolia, Kyrgyzstan, Mexico, USA, Chad, Trinidad and Tobago, Tanzania, Ecuador, Dominica etc.

Great Wall Group



PRODUCTION CAPABILITY

Strict production and management system will optimize the allocation of production resources, so that our high end production equipments do it's ut most to complete the task.

The company covers an area of 60,000 m2, up to 60,000 tons of steel bridge production per year.



RECOGNITION

Starting at its establishment, the company has been engaging in the designing, developing, manufacturing, erecting and maintaining of modular steel bridge/bailey bridge/portable bridge and its affiliated components.

Our products are well recognized and have a good reputation across the world.

PRODUCT FEATURES

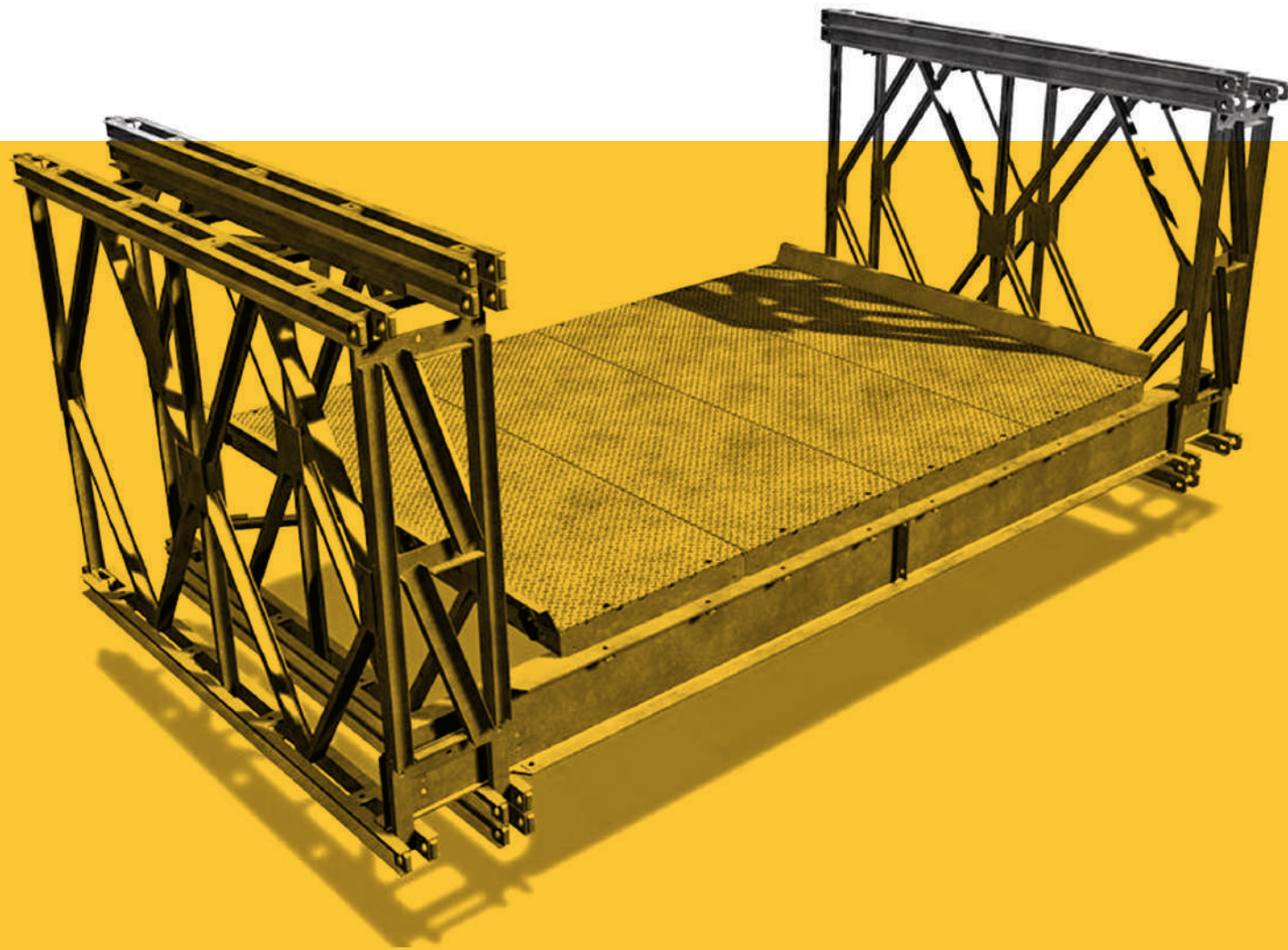

PRE-FABRICATED HEAVY DUTY MODULAR STEEL BRIDGE

The bridge system which consists of several modular components are engineered specifically to facilitate rapid construction needs and long span requirements.

It is highly suitable for both temporary and permanent solutions, whether its remote and rural locations or to provide emergency relief for disaster affected areas.



SIMPLE & QUICK ASSEMBLY

The components of this bridge system is made to be simple for assembly, even by unskilled personnel



MODULAR & MULTI CONFIGURATIONS

Designed to be versatile, the bridge can be constructed into various configurations to meet required length, span and load capacity with configuration 1 or 2 lanes of passageways for both military and civilian usage



ROBUST & HEAVY DUTY

Each components including deckings are fully galvanized to withstand tough usage and rough weather for long lasting life and very minimum maintenance. The bridge also capable to sustain various loading up to 100 tonnes



PORTABLE & RELOCATABLE

The bridge system is designed as modular components to maximize it's reusability and making it easy to transport/relocate to other places



CANTILEVER LAUNCH

For rapid solution requirements, the bridge is designed to be launched without the need of supporting structures such as piers in between, for up to 60.96m of gap



TROPICALISED

Operating & Storage Temperature: up to 60° C
Operating & Storage Humidity: up to 95% RH



Should be required, we are able to provide lessons and training to ground personnel



Further detailed information and specification are available in our Technical Documentation

PRODUCT FEATURES

These are the main components of the GW Modular Steel Bridge

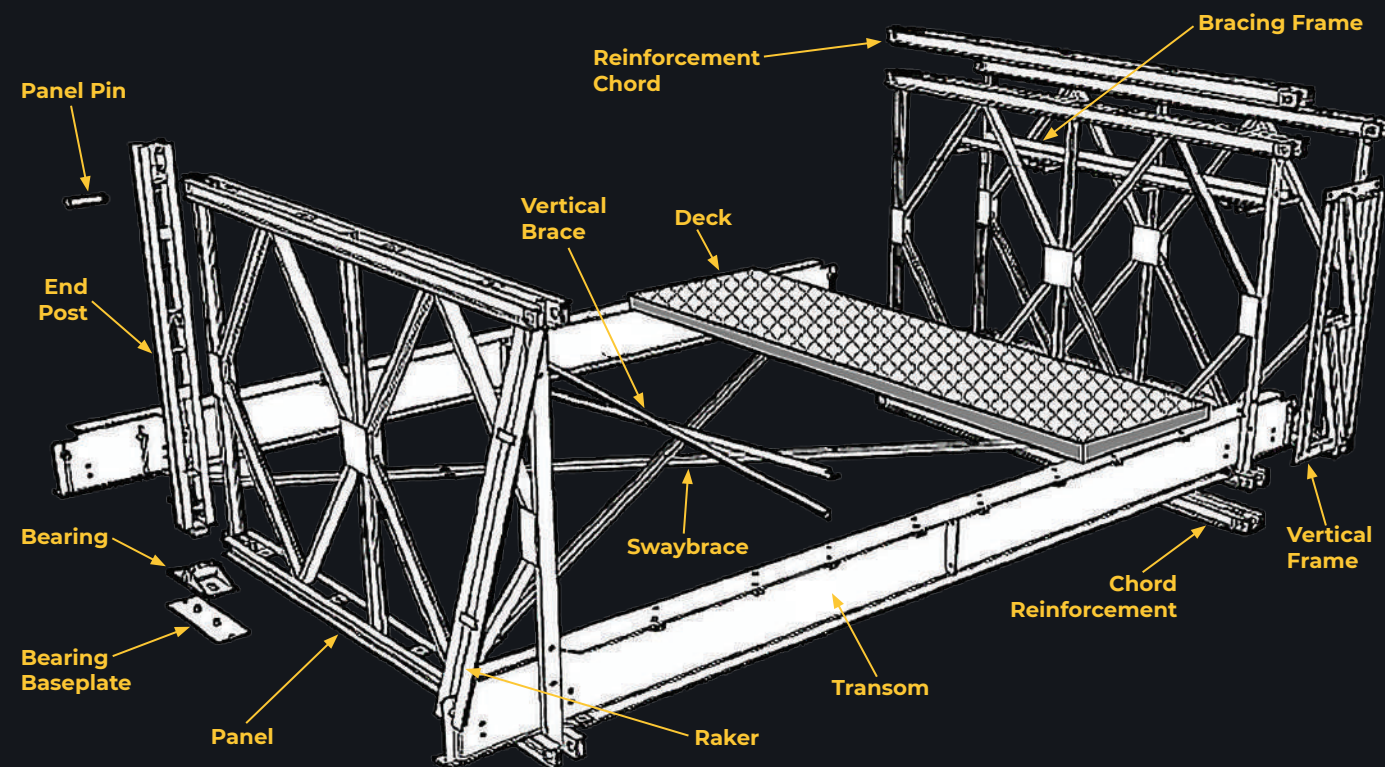

TRUSS CONSTRUCTION

The GW Modular Steel Bridge can be configured into various truss constructions

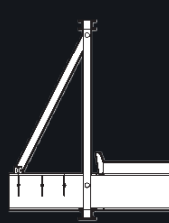

SS

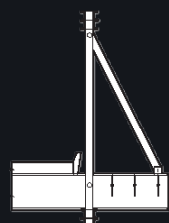

SSR

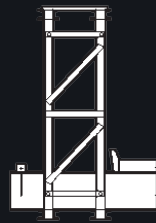

DS

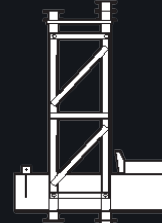

DSR1

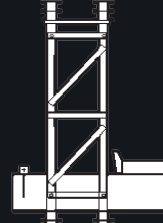

DSR2

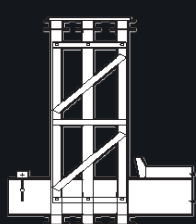

TS

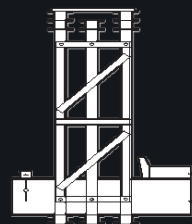

TSR2

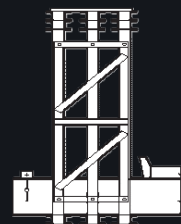

TSR3



QS



QSR3



QSR4

TECHNICAL SPECIFICATION

ZB 100

01 | Span

30ft up to 140ft (10ft increment)
9.144m up to 42.67m (3.048m increment)

02 | Roadway Width

Single Lane - 4.2 m

03 | Material Grade

High Strength Alloy Steel
(BS and ISO compliances)

04 | Load Standard

Civilian Load:
HA Loading

Military Load:
Up to MLC 60 (Tracked) / (Wheeled)

05 | Corrosion Protection

Hot Dip Galvanized

06 | Deck Surface

Raised Skid Resistant

07 | Joint System

Pin & Bolt System

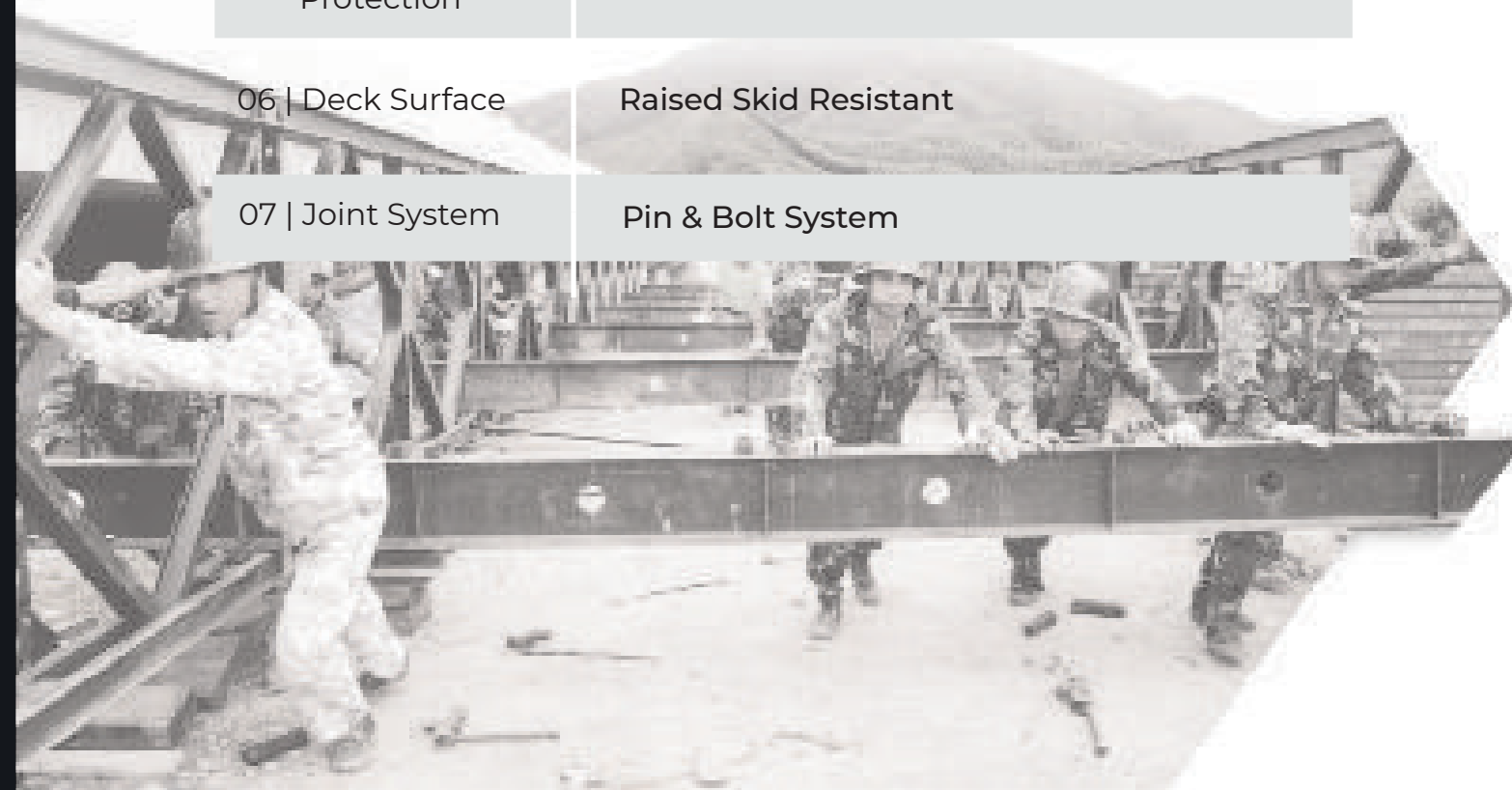

TECHNICAL SPECIFICATION

ZB 200

01 | Span

30ft up to 200ft (10ft increment)
9.144m up to 6096m (3.048m increment)

02 | Roadway Width

Single Lane - 4.2 m
(with additional component, the bridge can convert to Double Lane 7.35m width)

03 | Material Grade

High Strength Alloy Steel
(BS and ISO compliances)

04 | Load Standard

Civilian Load:
HA/HB Loading
HS25

Military Load:
Up to MLC 80 (Tracked) / MLC 110 (Wheeled)

05 | Corrosion Protection

Hot Dip Galvanized

06 | Deck Surface

Raised Skid Resistant

07 | Joint System

Pin & Bolt System

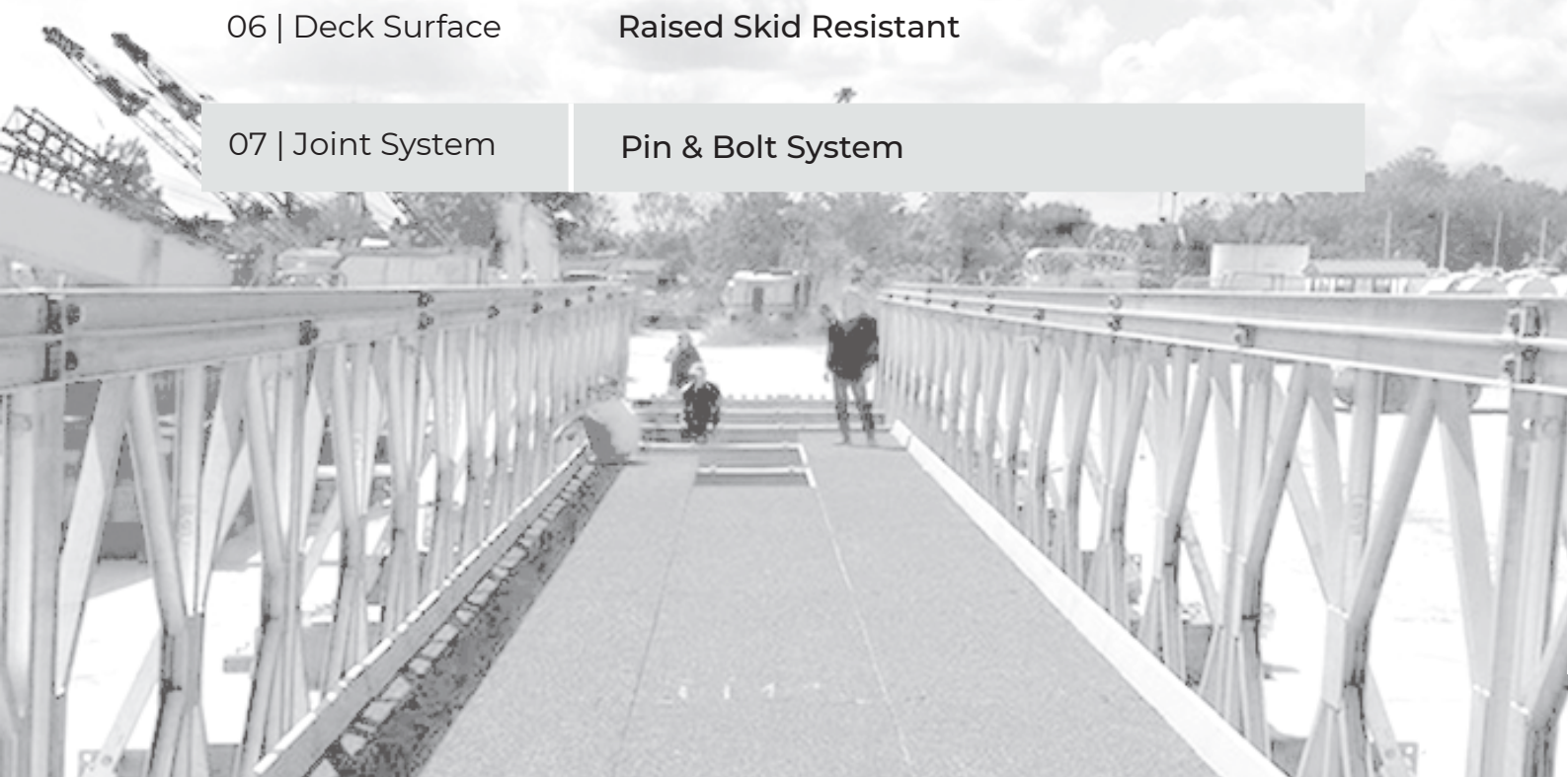

ERECTION & INSTALLATION

CANTILEVER LAUNCH

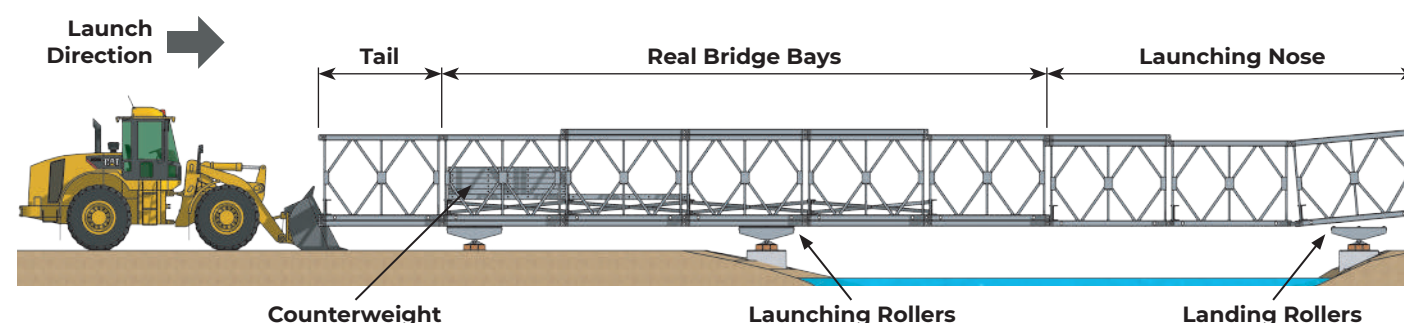

INTERNATIONAL PROVEN

Our products have been used in various countries around the world

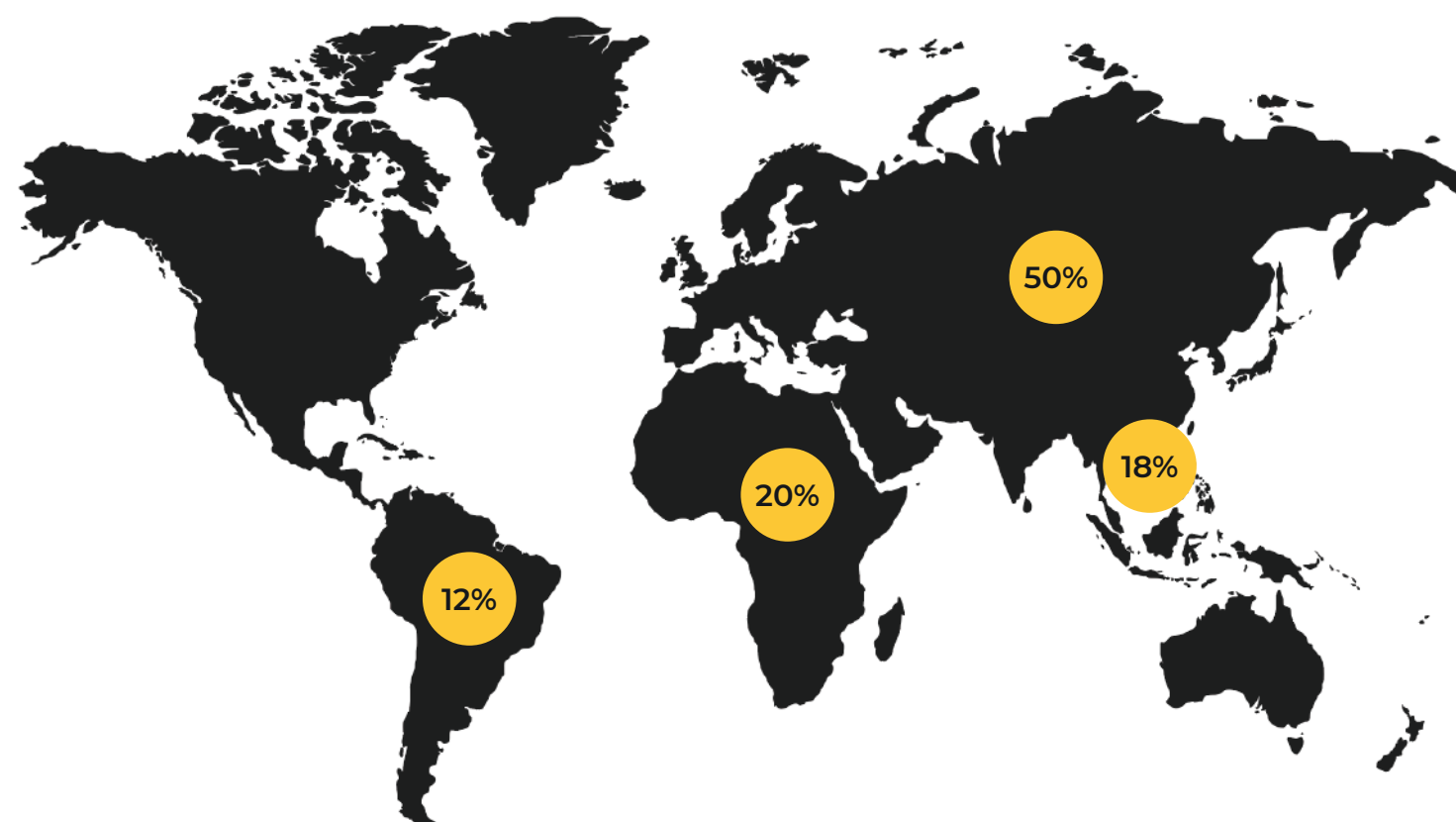

PREVIOUS PROJECTS & CLIENTS

ZB 100

01. MYANMAR

Single lane DS - 3.15m



02. CAMBODIA

Multi-span SSR - 183m



04. TANZANIA

Two span DSR single lane with walkway



ZB 200



02. INDONESIA

Single lane DSR - 15.25m



04. MONGOLIA

Multi-span TSR two ways - 150m

01. MYANMAR

Double lane TSR - 330m



03. MALAYSIA

Double lane TSR - 24.384m

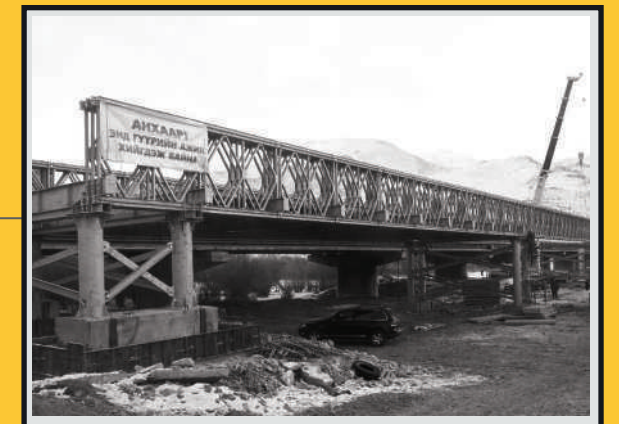



China National
Accreditation
Service



American
Welding
Society®



BUREAU
VERITAS



Société Générale
de Surveillance



International
Organization for
Standardization

Original Manufacturer



📍 Zhenjiang Great Wall Heavy
Industry Technology Co. Ltd.
No. 103, Nanxu Road,
High-Tech Zone, Zhenjiang
Jiangsu, China

✉️ greatwallgroup@foxmail.com

Authorised Distributor



📍 STARE Resources Sdn Bhd
Lot 2-4-29 Fourth Floor Wisma
Rampai, Jalan 34/26 Taman Sri
Rampai, 53000 ,Setapak,
Kuala Lumpur, Malaysia

✉️ stare.com.my